

Application to vary a premises licence under the Licensing Act 2003

PLEASE READ THE FOLLOWING INSTRUCTIONS FIRST

Before completing this form please read the guidance notes at the end of the form. If you are completing this form by hand please write legibly in block capitals. In all cases ensure that your answers are inside the boxes and written in black ink. Use additional sheets if necessary.

You may wish to keep a copy of the completed form for your records.

I/We Punch Taverns Limited

(Insert name(s) of applicant)

being the premises licence holder, apply to vary a premises licence under section 34 of the Licensing Act 2003 for the premises described in Part 1 below

Premises licence number PL(A)0449

Part 1 – Premises Details

Postal address of premises or, if none, ordnance survey map reference or description			
--	--	--	--

Duke Of Cumberland 1 Appleby Road			
--------------------------------------	--	--	--

Post town	Kendal	Postcode	LA9 6ES
-----------	--------	----------	---------

Telephone number at premises (if any)	n/a
Non-domestic rateable value of premises	£12750.00

Brief description of premises (Please see Guidance Note 2) Public house

Part 2 – Applicant details

Daytime contact telephone number	+44(0)3330 061999
E-mail address (optional)	PunchLicensing@TLT.com

Current postal address if different from premises address	Jubilee House Second Avenue		
Post town	Burton upon Trent	Postcode	DE14 2WF

Part 3 - Variation

Please tick as appropriate

Do you want the proposed variation to have effect as soon as possible? ☒ Yes ☐ No

If not, from what date do you want the variation to take effect?

DD	MM	YYYY

Do you want the proposed variation to have effect in relation to the introduction of the late night levy?
(Please see guidance note 1) ☐ Yes ☒ No

Please describe briefly the nature of the proposed variation (Please see guidance note 2)

This is an application to vary the layout and design of the premises in accordance with the submitted plan (drawing no H2507060/01).

The change consists of permitting the use of an external food/drink dispense bar, for the sale and supply of alcohol, as shown the proposed plan.

The locations of fire safety and other safety equipment subject to change in accordance with the requirements of the responsible authorities or following a risk assessment.

Any detail shown on the plan that is not required by the licensing plans regulations is indicative only and subject to change at any time.

Conditions proposed below to relate to the use of the external bar servery for licensable activities;

- The external bar servery will operate for the sale and supply of alcohol until 21:30h on any day it is in operation.
- When the sale of alcohol takes place from the external servery, regular checks of the garden will include the removal of empty glasses and bottles.
- Whenever the external servery is operational, a sufficient number of staff members, which will be determined on a risk assessed basis, will operate, monitor and supervise the area for customer behaviour and to monitor noise levels.

All other permitted hours and activities currently permitted by the premises are to remain unchanged by this application.

If your proposed variation would mean that 5,000 or more people are expected to attend the premises at any one time, please state the number expected to attend:

n/a

Part 4 Operating Schedule

Please complete those parts of the Operating Schedule below which would be subject to change if this application to vary is successful.

Provision of regulated entertainment (Please see guidance note 3)

Please tick all that apply

- a) plays (if ticking yes, fill in box A) ☐
- b) films (if ticking yes, fill in box B) ☐
- c) indoor sporting events (if ticking yes, fill in box C) ☐
- d) boxing or wrestling entertainment (if ticking yes, fill in box D) ☐
- e) live music (if ticking yes, fill in box E) ☐
- f) recorded music (if ticking yes, fill in box F) ☐
- g) performances of dance (if ticking yes, fill in box G) ☐
- h) anything of a similar description to that falling within (e), (f) or (g)
(if ticking yes, fill in box H) ☐

Provision of late night refreshment (if ticking yes, fill in box I) ☐

Supply of alcohol (if ticking yes, fill in box J) ☐

In all cases complete boxes K, L and M

A

Plays Standard days and timings (please read guidance note 8)			<u>Will the performance of a play take place indoors or outdoors or both – please tick</u> (please read guidance note 4)	Indoors	<input type="checkbox"/>
				Outdoors	<input type="checkbox"/>
				Both	<input type="checkbox"/>
Day	Start	Finish	<u>Please give further details here</u> (please read guidance note 5)		
Mon					
Tue					
			<u>State any seasonal variations for performing plays</u> (please read guidance note 6)		
Wed					
Thur					
			<u>Non standard timings. Where you intend to use the premises for the performance of plays at different times to those listed in the column on the left, please list</u> (please read guidance note 7)		
Fri					
Sat					
Sun					

B

Films Standard days and timings (please read guidance note 8)			<u>Will the exhibition of films take place indoors or outdoors or both – please tick</u> (please read guidance note 4)	Indoors	<input type="checkbox"/>
				Outdoors	<input type="checkbox"/>
				Both	<input type="checkbox"/>
Day	Start	Finish	<u>Please give further details here</u> (please read guidance note 5)		
Mon					
Tue					
			<u>State any seasonal variations for the exhibition of films</u> (please read guidance note 6)		
Wed					
Thur					
			<u>Non standard timings. Where you intend to use the premises for the exhibition of films at different times to those listed in the column on the left, please list</u> (please read guidance note 7)		
Fri					
Sat					
Sun					

C

Indoor sporting events Standard days and timings (please read guidance note 8)			<u>Please give further details</u> (please read guidance note 5)
Day	Start	Finish	
Mon			
Tue			<u>State any seasonal variations for indoor sporting events</u> (please read guidance note 6)
Wed			
Thur			
Fri			<u>Non standard timings. Where you intend to use the premises for indoor sporting events at different times to those listed in the column on the left, please list</u> (please read guidance note 7)
Sat			
Sun			

D

Boxing or wrestling entertainments Standard days and timings (please read guidance note 8)			<u>Will the boxing or wrestling entertainment take place indoors or outdoors or both – please tick</u> (please read guidance note 4)	Indoors	<input type="checkbox"/>
				Outdoors	<input type="checkbox"/>
				Both	<input type="checkbox"/>
Day	Start	Finish			
Mon			<u>Please give further details here</u> (please read guidance note 5)		
Tue					
Wed			<u>State any seasonal variations for boxing or wrestling entertainment</u> (please read guidance note 6)		
Thur					
Fri			<u>Non standard timings. Where you intend to use the premises for boxing or wrestling entertainment at different times to those listed in the column on the left, please list</u> (please read guidance note 7)		
Sat					
Sun					

E

Live music Standard days and timings (please read guidance note 8)			<u>Will the performance of live music take place indoors or outdoors or both – please tick</u> (please read guidance note 4)	Indoors	<input type="checkbox"/>
				Outdoors	<input type="checkbox"/>
				Both	<input type="checkbox"/>
Day	Start	Finish			
Mon			<u>Please give further details here</u> (please read guidance note 5)		
Tue					
Wed			<u>State any seasonal variations for the performance of live music</u> (please read guidance note 6)		
Thur					
Fri			<u>Non standard timings. Where you intend to use the premises for the performance of live music at different times to those listed in the column on the left, please list</u> (please read guidance note 7)		
Sat					
Sun					

F

Recorded music Standard days and timings (please read guidance note 8)			<u>Will the playing of recorded music take place indoors or outdoors or both – please tick</u> (please read guidance note 4)	Indoors	<input type="checkbox"/>
				Outdoors	<input type="checkbox"/>
				Both	<input type="checkbox"/>
Day	Start	Finish	<u>Please give further details here</u> (please read guidance note 5)		
Mon					
Tue					
			<u>State any seasonal variations for the playing of recorded music</u> (please read guidance note 6)		
Wed					
Thur					
			<u>Non standard timings. Where you intend to use the premises for the playing of recorded music at different times to those listed in the column on the left, please list</u> (please read guidance note 7)		
Fri					
Sat					
Sun					

G

Performances of dance Standard days and timings (please read guidance note 8)			<u>Will the performance of dance take place indoors or outdoors or both – please tick</u> (please read guidance note 4)	Indoors	<input type="checkbox"/>
				Outdoors	<input type="checkbox"/>
				Both	<input type="checkbox"/>
Day	Start	Finish			
Mon			<u>Please give further details here</u> (please read guidance note 5)		
Tue					
Wed			<u>State any seasonal variations for the performance of dance</u> (please read guidance note 6)		
Thur					
Fri			<u>Non standard timings. Where you intend to use the premises for the performance of dance at different times to those listed in the column on the left, please list</u> (please read guidance note 7)		
Sat					
Sun					

H

Anything of a similar description to that falling within (e), (f) or (g) Standard days and timings (please read guidance note 8)			Please give a description of the type of entertainment you will be providing		
Day	Start	Finish	<u>Will this entertainment take place indoors or outdoors or both – please tick</u> (please read guidance note 4)	Indoors	<input type="checkbox"/>
Mon				Outdoors	<input type="checkbox"/>
				Both	<input type="checkbox"/>
Tue			<u>Please give further details here</u> (please read guidance note 5)		
Wed					
Thur			<u>State any seasonal variations for entertainment of a similar description to that falling within (e), (f) or (g)</u> (please read guidance note 6)		
Fri					
Sat			<u>Non standard timings. Where you intend to use the premises for the entertainment of a similar description to that falling within (e), (f) or (g) at different times to those listed in the column on the left, please list</u> (please read guidance note 7)		
Sun					

I

Late night refreshment Standard days and timings (please read guidance note 8)			<u>Will the provision of late night refreshment take place indoors or outdoors or both – please tick</u> (please read guidance note 4)	Indoors	<input type="checkbox"/>
				Outdoors	<input type="checkbox"/>
				Both	<input type="checkbox"/>
Day	Start	Finish			
Mon			<u>Please give further details here</u> (please read guidance note 5)		
Tue					
Wed			<u>State any seasonal variations for the provision of late night refreshment</u> (please read guidance note 6)		
Thur					
Fri			<u>Non standard timings. Where you intend to use the premises for the provision of late night refreshment at different times, to those listed in the column on the left, please list</u> (please read guidance note 7)		
Sat					
Sun					

J

Supply of alcohol Standard days and timings (please read guidance note 8)			Will the supply of alcohol be for consumption – please tick (please read guidance note 9)		On the premises	<input type="checkbox"/>		
					Off the premises	<input type="checkbox"/>		
					Both	<input type="checkbox"/>		
Day	Start	Finish	State any seasonal variations for the supply of alcohol (please read guidance note 6)					
Mon								
Tue								
Wed								
Thur							Non-standard timings. Where you intend to use the premises for the supply of alcohol at different times to those listed in the column on the left, please list (please read guidance note 7)	
Fri								
Sat								
Sun								

K

Please highlight any adult entertainment or services, activities, other entertainment or matters ancillary to the use of the premises that may give rise to concern in respect of children (please read guidance note 10).

L

Hours premises are open to the public Standard days and timings (please read guidance note 8)			<u>State any seasonal variations</u> (please read guidance note 6)
Day	Start	Finish	
Mon			
Tue			
Wed			
Thur			
Fri			<u>Non standard timings. Where you intend the premises to be open to the public at different times from those listed in the column on the left, please list</u> (please read guidance note 7)
Sat			
Sun			

Please identify those conditions currently imposed on the licence which you believe could be removed as a consequence of the proposed variation you are seeking.

Please tick as appropriate

- I have enclosed the premises licence ☐
- I have enclosed the relevant part of the premises licence ☐

If you have not ticked one of these boxes, please fill in reasons for not including the licence or part of it below

Reasons why I have not enclosed the premises licence or relevant part of premises licence.

M Describe any additional steps you intend to take to promote the four licensing objectives as a result of the proposed variation:

a) General – all four licensing objectives (b, c, d and e) (please read guidance note 11)

As per current licence, save for those conditions added by way of this application;

Conditions proposed below to relate to the use of the external bar servery for licensable activities;

- The external bar servery will operate for the sale and supply of alcohol until 21:30h on any day it is in operation.
- When the sale of alcohol takes place from the external servery, regular checks of the garden will include the removal of empty glasses and bottles.
- Whenever the external servery is operational, a sufficient number of staff members, which will be determined on a risk assessed basis, will operate, monitor and supervise the area for customer behaviour and to monitor noise levels.

b) The prevention of crime and disorder

c) Public safety

d) The prevention of public nuisance

e) The protection of children from harm

--

Checklist:

Please tick to indicate agreement

- I have made or enclosed payment of the fee; or ☒
- I have not made or enclosed payment of the fee because this application has been made in relation to the introduction of the late night levy. ☐
- I have sent copies of this application and the plan to responsible authorities and others where applicable. ☒
- I understand that I must now advertise my application. ☒
- I have enclosed the premises licence or relevant part of it or explanation. ☒
- I understand that if I do not comply with the above requirements my application will be rejected. ☒

IT IS AN OFFENCE, UNDER SECTION 158 OF THE LICENSING ACT 2003, TO MAKE A FALSE STATEMENT IN OR IN CONNECTION WITH THIS APPLICATION. THOSE WHO MAKE A FALSE STATEMENT MAY BE LIABLE ON SUMMARY CONVICTION TO A FINE OF ANY AMOUNT.

Part 5 – Signatures (please read guidance note 12)

Signature of applicant (the current premises licence holder) or applicant's solicitor or other duly authorised agent (please read guidance note 13). **If signing on behalf of the applicant, please state in what capacity.**

Signature	 Piers Warne of TLT Solicitors
Date	29 January 2026
Capacity	Solicitor to Applicant

Where the premises licence is jointly held, signature of 2nd applicant (the current premises licence holder) or 2nd applicant's solicitor or other authorised agent (please read guidance note 14). **If signing on behalf of the applicant, please state in what capacity.**

Signature	
-----------	--

Date	
Capacity	

Contact name (where not previously given) and address for correspondence associated with this application (please read guidance note 15) Paul Uren TLT Solicitors One Redcliff Street			
Post town	Bristol	Post code	BS1 6TP
Telephone number (if any)	+44 (0)333 006 0213		
If you would prefer us to correspond with you by e-mail, your e-mail address (optional) Paul.Uren@TLT.com			

Ground Floor and External Areas

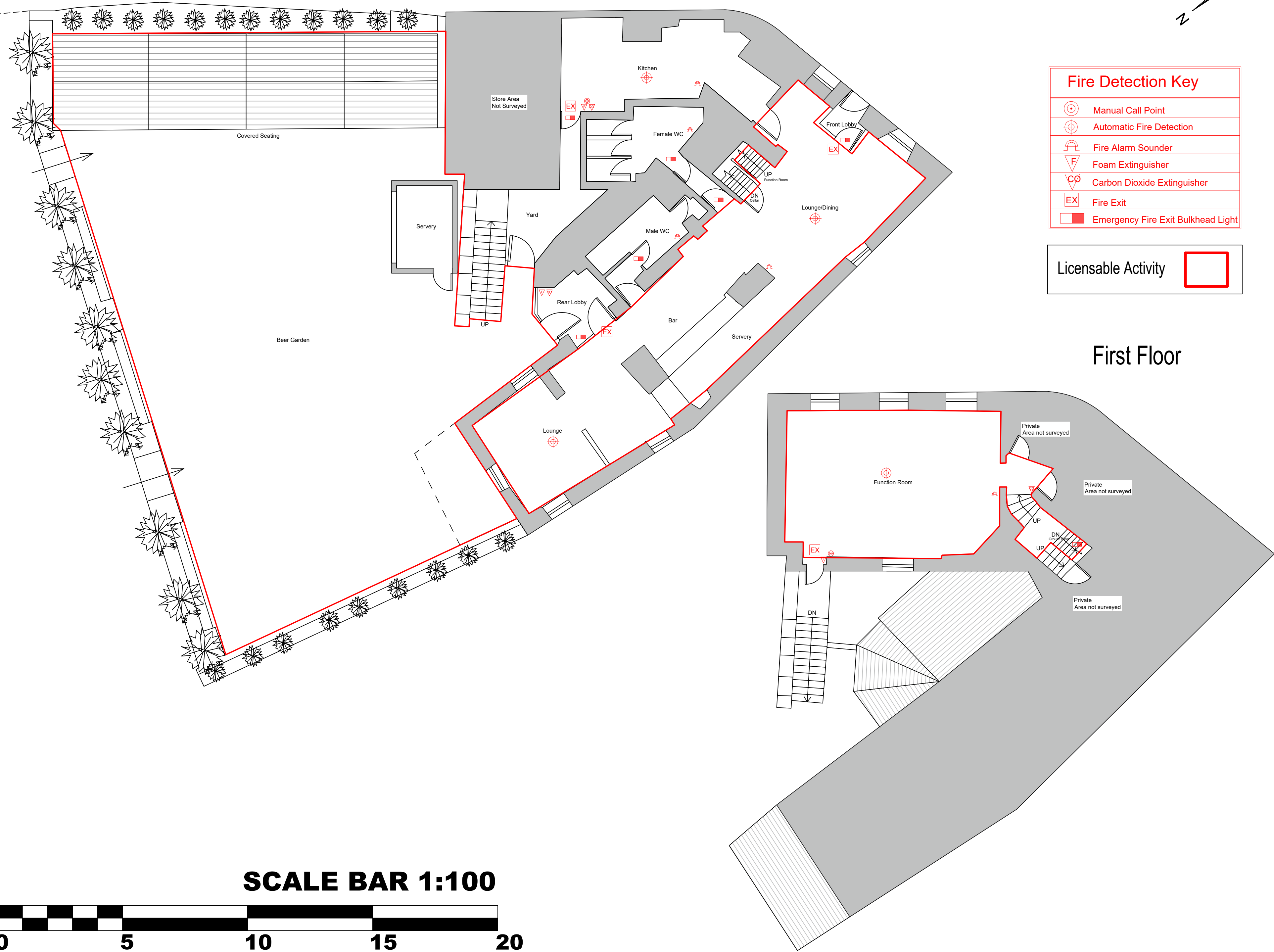

Fire Detection Key

	Manual Call Point
	Automatic Fire Detection
	Fire Alarm Sounder
	Foam Extinguisher
	Carbon Dioxide Extinguisher
	Fire Exit
	Emergency Fire Exit Bulkhead Light

Licensable Activity

First Floor

Notes:
This drawing is the property of Wakefields Chartered Building Surveyors. Copyright is reserved and the drawing is issued on the condition that it is not copied in whole or in part without the express written consent of Wakefields Chartered Building Surveyors.

All dimensions must be checked on site prior to commencement of the works. Any inconsistencies to be brought to the attention of the CA.

NOTES

STATUS
LICENSE PLAN

Revision	Date



32 Leazes Park Road, Newcastle upon Tyne, NE1 4PG
Tel: 0191 261 0601
Fax: 0191 222 1385
E Mail: surveyors@wakefieldscbs.co.uk
www.wakefieldscbs.co.uk

LICENSE PLAN
of
THE DUKE OF CUMBERLAND
1 APPLEBY ROAD
KENDAL
LA9 6ES

Title
Ground and First Floor Plans

Drawing no. H2507060/01	Revision -
----------------------------	---------------

Scale 1:100 @ A2	Drawn AM	Checked SN	Date Aug 2025
---------------------	-------------	---------------	------------------

**LICENSING ACT 2003:
APPLICATION TO VARY PREMISES LICENCE**

Notice is hereby given that Punch Taverns Limited has applied to Westmoreland and Furness Council in respect of Duke Of Cumberland 1 Appleby Road Kendal LA9 6ES for an application to vary the premises licence under the Licensing Act 2003 to permit the following:

This is an application to vary the layout and design of the premises in accordance with the submitted plan (drawing no H2507060/01).

The change consists of permitting the use of an external food/drink dispense bar, for the sale and supply of alcohol, as shown the proposed plan. It is proposed the external bar servery will operate for the sale and supply of alcohol until 21:30h on any day it is in operation.

To also add further conditions relating to the operation of the external bar, in which to further promote the licensing objectives, which can be viewed on the full application by contacting the local authority.

All other permitted hours and activities currently permitted by the premises are to remain unchanged by this application.

Any representations regarding the above mentioned application must be received in writing by Kendal - Public Protection (Licensing), South Lakeland District Council, South Lakeland House, Lowther Street, Kendal, Cumbria, LA9 4UQ or email:

licensing@westmorlandandfurness.gov.uk no later than the end of 26th February 2026 stating the grounds for the representation.

The register and the record of this application may be inspected at the Council office at the address given above between 10.00 - 16:00.

Monday to Friday or on the council's website -
www.westmorlandandfurness.gov.uk

It is an offence to knowingly or recklessly make a false statement in connection with this application. Persons will be liable on summary conviction to an unlimited fine.